

# FIRST STEPS



ŠKODA AUTO University



*Mladá Boleslav*



<b>INTRODUCTION .....</b>	<b>3</b>
<b>FACTS ABOUT ŠKODA AUTO University .....</b>	<b>4</b>
<b>PRACTICAL INFORMATION ABOUT STUDIES.....</b>	<b>7</b>
Academic year .....	7
Teaching .....	7
Credit system .....	7
Academic Information System (AIS) .....	8
ISIC/ALIVE card .....	8
Orientation of the university campus .....	9
Copy machines .....	10
Lockers .....	10
Library .....	10
Internet .....	10
Student Union .....	10
<b>RESIDENCE ISSUES .....</b>	<b>12</b>
Residence permit .....	12
Obligations upon arrival .....	13
Registration at Foreign Police Department.....	13
Registration for waste collection fee .....	13
Obligations during studying .....	14
1. Applying for an extension of your long-term visa/long-term permit.....	14
2. Reporting changes .....	15
3. Information related to the long-term residence permit for the purpose of study.....	15
4. I am a student of ŠKODA AUTO University and I will be going home for the summer holiday and returning back in September. How should I proceed to extend my stay in the Czech Republic? .....	15
5. General information .....	16
<b>PRACTICAL INFORMATION ABOUT LIVING IN MLADÁ BOLESLAV .....</b>	<b>18</b>
Accommodation .....	18
Public transport .....	18
Telecommunications .....	18
Foreign Currency Exchange Offices.....	18
Library of Mladá Boleslav .....	19
Culture .....	19
Shopping .....	19
Sport .....	20
Food & Drink .....	21

Tips for Trips .....	23
Health care .....	25
<b>FACTS ABOUT THE CZECH REPUBLIC .....</b>	<b>26</b>
Introduction .....	26
Geography .....	27
History.....	28
Living in the Czech Republic .....	29
Education system.....	31
<b>TRANSPORT IN THE CZECH REPUBLIC .....</b>	<b>34</b>
Public transport .....	34
Public transport in Prague .....	34
The right to drive .....	35
How to Get From Prague Airport to Mladá Boleslav .....	36
How to Get to ŠKODA AUTO University / Na Karmeli (Accommodation) .....	37
How to Get to Pension UNO (Accommodation) .....	39
Useful Links.....	41
<b>MAP OF MLADÁ BOLESLAV AND IMPORTANT PLACES .....</b>	<b>42</b>
<b>IMPORTANT CONTACTS .....</b>	<b>44</b>

## INTRODUCTION

You have decided to study at ŠKODA AUTO University and have already received an offer for a place on your chosen study programme. The aim of this brochure is to make your first steps as a student at ŠKODA AUTO University a little bit easier. The brochure provides you with all sorts of information to make your start a successful one.

We wish you success with your studies and entertaining student life at ŠKODA AUTO University.

## FACTS ABOUT ŠKODA AUTO University

### History

ŠKODA AUTO University was founded in 2000 as the first and so far the only company university in the Czech Republic. Its founder ŠKODA AUTO is seated in Mladá Boleslav and is one of the most important and most dynamically evolving companies in the Czech Republic and one of the largest brands of the Volkswagen group.



Since 2005 ŠKODA AUTO University has been a part of the Erasmus programme. In 2007 ŠKODA AUTO University received the Erasmus Extended University Charter.



ŠKODA AUTO University successfully passed the accreditation process of the American Accreditation Council for Business Schools and Programs in the year 2014, obtaining a prestigious institutional ACBSP accreditation according to all its standards. ACBSP accreditation is clearly beneficial both for students and graduates of ŠKODA AUTO University, adding a new dimension to their education and opening a path to other markets beyond Europe.

### Study programmes

#### Bachelor degree

- Business Administration and Sales
- Business Administration and Operations, Logistics and Quality Management
- Business Administration and Financial Management

#### Master degree

- Corporate Finance Management in the Global Environment
- Marketing Management in the Global Environment
- Business Administration and Operations
- Law in the Global Business Environment

#### Preparation course

- Czech language and culture for foreigners

**1 200 students** from the Czech Republic and other countries

### Location

The university is located in the old historic part of the town and is easily reachable from the main bus station, the train station Ml. Boleslav-Město, and by car.

#### Town of Mladá Boleslav

Mladá Boleslav lies 50 km north-west of Prague, the capital of the Czech Republic. It is located on the perimeter of one of the most beautiful areas known as the Bohemian Paradise, which is a tourist area with many castles, chateaus, ruins and view-towers and other places of interest.

The town has a history older than a thousand years. After the second half of the 10th century prince Boleslav II founded a castle on the junction of the Jizera and the Klenice. A medieval town was established around the castle and has gradually developed over the years.

The town's recent history is strongly connected with the automotive industry. According to the last census, Mlada Boleslav has 44,000 inhabitants and one third of them are employees of ŠKODA AUTO a.s.

## ŠKODA AUTO

Few car companies can claim more than 100 years of continuous history. Our company is considered to be the third oldest in the world after Ford and Benz. In 1895 a bookseller V. Klement and a mechanic V. Laurin established a workroom for repairing bicycles. Four years later they constructed their first motorbike and in 1905 the first car was released under the name Laurin and Klement. In the period between the two world wars the company went through a tumultuous development, especially in 1925, when it became the part of Škoda company. After the Second World War the state was unwilling to invest monetary funds into Czech Business. In 1989 the Velvet Revolution swept communism from power, which resulted in a change of government. The following year the opportunity for innovation was opened and new business contacts were established. Essential reconstruction required financing and experience. A few large car companies put forward their plans and solutions. The best solution came from the Volkswagen Group and after its acceptance the corporation had 100 percent ownership.

## University structure:

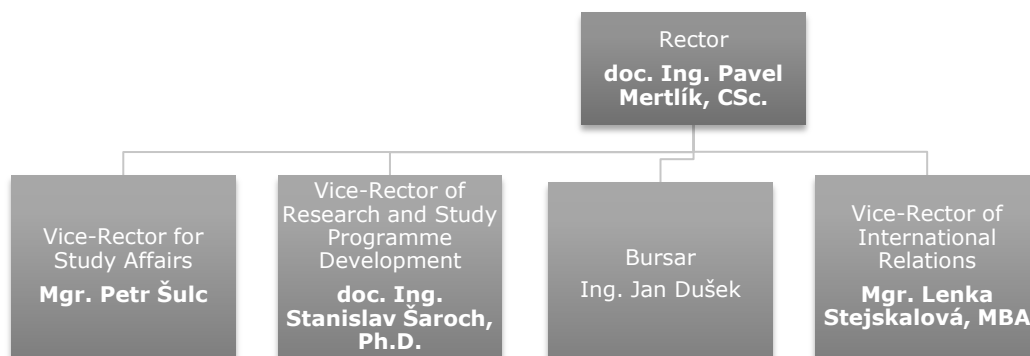

## Partner institutions:

Partner universities within the EU: Austria, Finland, France, Germany, Greece, Italy, Norway, Poland, Romania, Slovakia, Slovenia, Spain, Turkey, Portugal, Island, Ukraine, Bulgaria, Great Britain, Croatia

Partner universities outside the EU: China (Shanghai, Dalian), Russia, USA, India

Partners companies: Audi Germany, Škoda Auto Deutschland, Volkswagen Germany, Bentley Motors Ltd., Škoda Auto United Kingdom, VW United Kingdom, VW Group Ireland, Škoda Auto Slovakia, VW Slovakia, VW Shanghai, VW Beijing, Audi Changchun, Škoda Auto India Private, VW Moscow, Audi Soul

**Address:** ŠKODA AUTO University  
Na Karmeli 1457  
293 01 Mladá Boleslav  
Czech Republic



## PRACTICAL INFORMATION ABOUT STUDIES

### Academic year

The academic year is always divided into two semesters - winter and summer. Each semester lasts 12 weeks (with the exception of the 5<sup>th</sup> semester which is shorter). The end of the winter semester is followed by a five-week examination period.

Throughout the academic year, it is necessary to continuously monitor the information and instructions of the Study Affairs Department / International Office which is sent to your AIS email account (Academic Information System).



### Teaching

Classes at university are very different from classes at secondary schools as they are divided into two parts – lectures and practical seminars. Lectures take place in the main lecture halls and unlike practical seminars, they are sometimes not compulsory, however, this is defined by each lecturer individually. Students often perceive lectures as bothersome and counterproductive, whereas they are the main source of information for practical seminars and exams. Although they might not be exactly entertaining, attending them is worthwhile, because lecturers have a tendency to remember students who are particularly active. One university lesson equates to 90 minutes and some courses have two consecutive blocks which are 180 minutes in length and, with a break of 15 minutes. Except for in the first semester, schedules are created by students themselves and the application for creation of schedules is only launched on certain dates.

### Credit system

Courses at ŠKODA AUTO University are evaluated using the credit system. Students may choose courses and create a study plan based on the rules of the specific study programme.

### Bachelor studies

Studies are complete after obtaining at least 180 credits in the specified structure. At least 168 credits must be obtained from the specified group of obligatory courses for the relevant field of study, of which 20 credits for the course of English language with target level of at least B2 and 17 credits for a second foreign language with a target level of at least A2. For all international students of the Bachelor's degree programme in Czech language, with the exception of Slovaks and international students who have successfully completed their studies at a Czech or Slovak secondary school or have submitted a certificate of Czech language exam for foreigners with a level of at least B2 SERR, the second foreign language shall be Czech language for academic purposes. These students can choose a third optional language course if they wish. In addition, students must obtain at least 12 credits from optional courses specific for the given field of study, which are typically scheduled for the 6th and 7th semester and their current offer is updated before registration for courses for the given semester. It is obligatory for students to complete at least one course taught in English during their studies. Internship is a mandatory part of the curriculum for full-time study.



Bachelor's degrees are awarded upon completion of:

- at least 180 credits gained in the manner set out by the field of specialisation
- the state exam;
- the successful defence of the Bachelor Thesis.

## Master studies

Studies are complete after obtaining at least 120 credits in the specified structure. At least 105 credits must be obtained from the specified group of obligatory courses for the relevant field of study, of which 18 credits for a foreign language course with target level of at least C1. In addition, you must obtain at least 15 credits from optional courses specific for the given field of study. At least 10 credits of the total 120 must be obtained in courses taught in a foreign language. The Master's study programme is concluded with a state exam, which includes the defence of the Diploma Thesis. Students of the Master's programme register for the state exam after having obtained 120 credits and finishing and submitting their Diploma Thesis.

Master's degrees are awarded upon completion of:

- at least 180 credits gained in the manner set out by the field of specialisation;
- successful defence of the Diploma Thesis;
- the state exam.

## Academic Information System (AIS)

The first important step you need for your studies at ŠKODA AUTO University is to become familiar with the Academic Information System (AIS) [is.savs.cz](https://is.savs.cz). This system is used for all communication between students and the university. The AIS can be used to find the office hours of teachers, timetables (your own, your classmates', teachers' or classroom schedules), the status of your studies, the number of completed courses, obtained credits and many other useful pieces of information. The system also stores documents of the Study Affairs Department (applications for scholarships, change of study mode etc.) and documents related to individual courses etc. As well in the document server is placed a folder for foreign students (Document tree > International office > Information for international students).

Another important AIS element is your e-mail account which is created for all students at the beginning of their studies. We recommend that you check it regularly as all important notifications regarding your studies are sent here. It is also possible to forward your mail to a personal e-mail account.

We also recommend that you regularly read the notice board, where you can find lots of other important information (e.g. job opportunities, lost and found items, accommodation and much more).

An important information channel for students is also the university Facebook page - [www.facebook.com/savs.mb](https://www.facebook.com/savs.mb), where you can find all the latest information about current events and activities.

## ISIC/ALIVE card

- entry to the Mediatéka and computer classrooms
- to pay for lunch or to use the copy machines



- the ISIC/ALIVE card is available for every ŠKODA AUTO University student for free

## Orientation of the university campus

- the campus is divided into three parts – buildings "A", "B" and "C"
- use to orientation maps located near to stairs in each floor

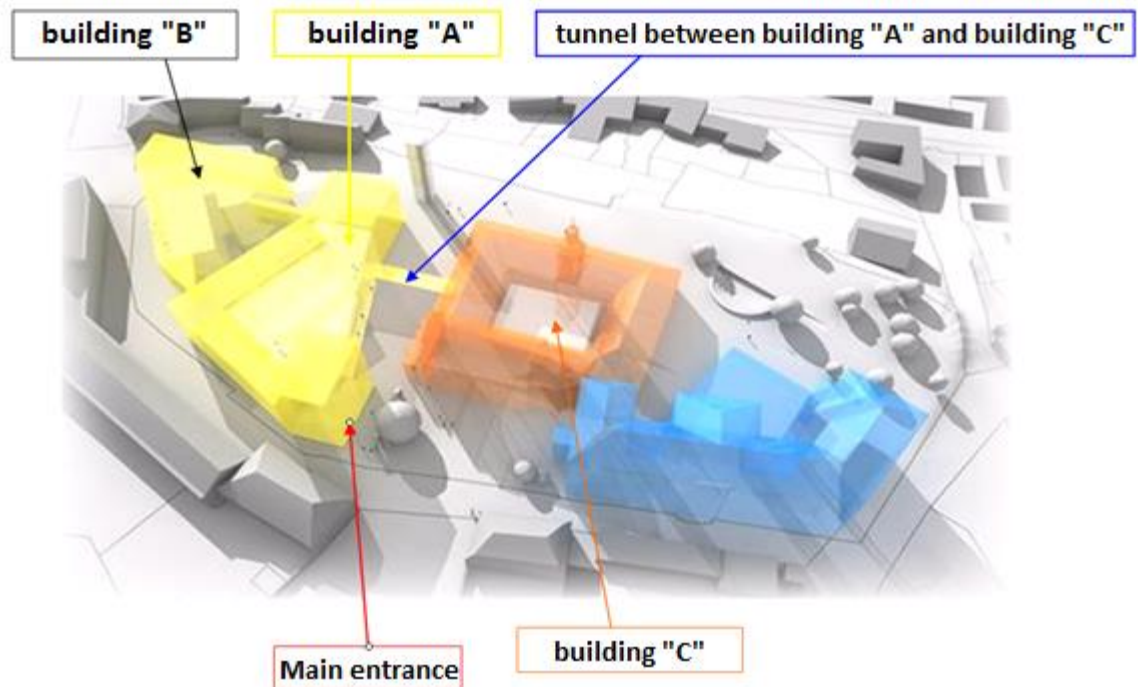

### Building "A"

- main area of ŠKODA AUTO University
- all lectures, classes, lessons are undertaken here
- the two main auditoriums (A014 and A015) are located on the ground floor
- the canteen is next to the main entrance

### Building "B"

- can be accessed from building "A" via the glass passages
- International Office and the Student union office

### Building "C"

- former piarist monastery with the church of St. Bonaventura
- to get here use the underpass from building "A" – next to reception in building "A" go to basement and the through tunnel to building "C"
- the library and Mediatéka (study room equipped with PC's)

In order for you to find your way around the campus you should become familiar with the numbering of the rooms.

- A229 – „A" represents the building, „2xx" means floor, „x29" is the room number
- A229 – „A" building, 2nd floor, room no. 29
- note: A-103 is not first floor, but „-" means the classrooms in the basement

## Mediatéka

- mediatéka is a study room equipped with computers and copy machines
- located in Building „C“
- for entry use your ISIC card
- for study purposes it is possible to use the computer classrooms in building “A” if there are no scheduled classes

## Copy machines

- the ISIC card can be used as a copy card
- you can credit your ISIC card at the top up machine on the second floor, opposite the Study Affairs Department
- please note the top up machine does not provide change
- it is only possible to obtain credit for copying and not for lunch

## Lockers

- lockers are provided for bags, coats and personal items
- located in the basement of building “A”
- keys are available at reception
- if you lose the key then you will be fined 50 CZK

## Library

The library is located in building ‘C’. Upon your first visit to the library, it is necessary to register by completing a form. After that, you will be allowed to borrow virtually any of books, and the loan period is two months. After it expires, it is possible to extend it by one month (or after personal consultation with the librarian for even more). If you do not extend the loan period (via e-mail, phone or in person), you risk large fines. If the loan period is overdue, you will be notified via e-mail, after which the book must be returned within 10 days, or you must get the loan period extended. The books with a green dot in the upper part of the front cover are on one day loan only. The library is fairly well equipped and every student usually acquires the desired titles. The library also has a reading room, where (unlike the media library) everyone can study in a truly peaceful and quiet environment.



## Internet

You will find free access in the study room (mediatéka) or in the computer classroom in the university building and there is free wi-fi on campus.

**Wi-fi named: VCNK**

**Password: karmel2010**

## Student Union

The Student Union was founded in 2008 as a civic association to develop and organise sporting and cultural activities for students at ŠKODA AUTO University.

**Activities:**

- language courses (English and German)
- football Tuesdays
- floorball Wednesdays
- volleyball Tuesdays
- bowling
- fitness
- trips
- discos
- school magazine
- lectures
- guest speakers

**Contact:**      facebook.com/savssu  
                     **susavs@seznam.cz**

**School canteen**

- weekdays only
- prices for lunch between 30 – 50 CZK
- brunch 8:30 – 9:45
- lunch 10:30 – 14:00
- the card for lunch can be added from 8:30 – 9:45
- provided by Eurest; **www.eurest.cz**

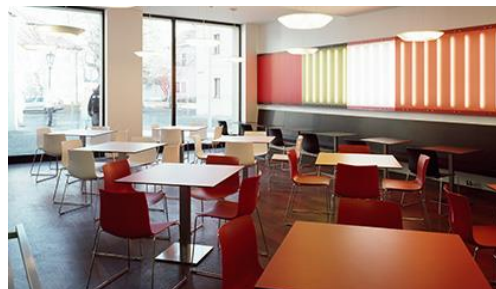

## RESIDENCE ISSUES

### Residence permit

Different residence permit may be needed for entering the Czech Republic and staying in the country, depending on the nationality of the individual and the reasons for entering the country.

#### EU citizens

EU citizens don't need a residence permit. However one of the obligations ensuing from the Act on the Residence of Foreign Nationals for citizens of the EU, Iceland, Norway, Liechtenstein, or Switzerland is the "reporting requirement" in the event that the length of the intended stay in the Czech Republic is longer than 30 days. In this situation, within 30 days of entering the Czech Republic, an individual is required to report his/her presence to the appropriate Foreign Police Department that holds jurisdiction in the location of his/her stay in the Czech Republic, unless your accommodation provider (a hotel or a student dorm) reported your arrival on your behalf.

#### Non-EU citizens

Non-EU citizens will need to apply either for long-term visa/long-term permit for the purpose of studying at the Czech Embassy or consulate in the country of permanent residence. Information providing you with the visa process are included in the document which has been sent to you with Notification of Admission called "Additional information for international applicants and applicants who received previous education abroad".

#### Make a distinction between a long-term visa and a long-term residence permit!

	<b>Long-term visa for the purpose of study</b>	<b>Long-term residence permit for the purpose of study</b>
In Czech	<b>Dlouhodobé vízum za účelem studia</b>	<b>Dlouhodobý pobyt za účelem studia</b>
Valid for	12 months	12 months up to 2 years
Basic information	It is not possible to change the purpose of the stay.  Long-term visa is stuck on a travel document.	It is possible to change the purpose of the stay.  Holder of long-term residence permit receives biometric card.

Applicants for a long-term visa must submit all required documents on the date of submitting the application. In case you fail to submit all required documents, you will need to book a new appointment via the VISAPPOINT. This will prolong the process considerably. If an applicant applies for a long-term residence and does not provide all documents on the day of the appointment, another appointment can be booked outside the VISAPPOINT system.

## Obligations upon arrival

### Registration at Foreign Police Department

Upon arrival, students from non-EU countries are obliged to **register after arrival within 3 working days** with the Foreign Police, if it has not been done by the accommodation provider. Students from EU countries have the same obligations. We recommend that students register in person.

Within 3 working days of entering the Czech Republic, all foreign students arriving to receive a long-term residence permit are obliged to report to the Ministry of the Interior office in person for the purpose of carrying out activities associated with issuing a biometric residence card.

If you left a telephone contact number upon filing your application, you shall be contacted at this number to arrange an appointment for having your biometric data collected, or else, to collect your residence card. If you did not provide a contact phone number or Ministry officials are unable to contact you, you shall be invited in writing to provide your biometric data, or to collect your residence card within a specified time limit. In this case, you can arrange an appointment at the Ministry in advance by telephone.

#### Foreign Police (Department for Asylum and Migration Policy)

Address: Štefánikova 1304  
Mladá Boleslav

Tel.: 974 820 680 (incl. telephone appointments)

Opening hours: Mo, We: 8.00 – 17.00  
Tu, Th: 8.00 – 14.00  
Fr: 8.00 – 11.00 (only for clients with an appointment)

The appointment at the Ministry officials can be arranged in advance over phone contact (as well from abroad). Otherwise your registration will be processed while-you-wait.

Official language is only Czech. Some officers are able to talk English however, we recommend that you prepare for the appointment or you have accompaniment. Students accepted for studying in English will have possibility to be accompanied during the Orientation week.

### Registration for waste collection fee

As of 1st January 2013 a new amendment to the Act n. 565/1990 Sb. about the local fees for municipal waste collection has come into force. According to the act **foreigners with residence in Mladá Boleslav are obligated to pay the waste collection fee.**

All foreign nationals registered at the Foreign Police in Mladá Boleslav staying in the Czech Republic (in Mladá Boleslav) **for more than 6 months** per calendar year have to register for the charge of waste disposal.

#### Sanctions for late or incomplete payment:

The fine for late payment may amount up to 5 000 CZK, unless the fee is paid on time. The fee may be assessed for up to 3 former years and late payment may also involve additional administration fees of up to 50 % of the fine.

The charge of waste disposal is about 400 CZK/year.

The payer has the duty to inform or the duty of the payer to report to the fee administrator the existence of facts resulting in the commencement (within 15 days after the registration at the

Foreign Police in Mladá Boleslav) or a right to exemption from the fee payment within 15 days of such a fact occurred.

As well as the payer is obliged to **report to the fee administrator the existence of facts resulting in change or termination** (it is e.g. in case you decide to leave Mladá Boleslav in long-term, usually after study termination) of the duty to pay within 15 days of such a fact occurred.

Unless the payer informs the fee administrator about the existence of facts resulting in change or termination, sanctions for late or incomplete payment will be charged.

To register for the charge of waste disposal is possible:

- in person in the office no. 304, 3rd floor in Mladá Boleslav City Municipality (address: Komenského náměstí (square) 61, Mladá Boleslav)
- electronically – the enclosed form must be filled, signed and sent in format pdf at [krizkovar@mb-net.cz](mailto:krizkovar@mb-net.cz)

The City Municipality sends every April and October postal money order at address specified at the register form. The payment can be transferred half-yearly (2 x 200 CZK) or yearly (1 x 400 CZK).

It is recommended checking up-dated information at [www.mb-net.cz](http://www.mb-net.cz)

With respect to tax administration, the documents and meetings are only written/conducted only in Czech. Therefore, the application must be submitted in the Czech language.

The application form is available in excel document on <http://www.mb-net.cz/komunalni-odpad/ds-1006/archiv=0&p1=1016>.

## Obligations during studying

### 1. Applying for an extension of your long-term visa/long-term permit

**When:** within 120 days and at least 1 day prior to the expiry date of the previous residence permit. If the last day of validity of the long-term visa or long-term residence permit is a non-working day (Saturday, Sunday, holiday), the last day the application may be submitted by a foreign national is the closest PREVIOUS working day. In the event that the end of the validity period is a working day which is not an office day, the application for validity extension of a long-term residence permit may be submitted for mail delivery on the last day of this period. This does not apply to applications that must be submitted in person; these applications must be delivered to the Ministry of the Interior no later than on the last day of the validity period. The fact that the last day of the validity period is a working day but not an office day, cannot generally be considered a reason, regardless of the cause, to prevent a foreign national from submitting the application. For this reason, all applications must be submitted in advance. **Where:** at the relevant office of the Ministry of the Interior. **How:** in person, by registered post or through an authorized representative.

#### **What are the requirements of an application for an extension of a long-term visa/long-term permit?**

1) Travel document; 2) study confirmation for following semester; 3) accommodation confirmation; 4) confirmation of sufficient financial resources for your stay; 5) confirmation of medical insurance in the Czech Republic; 6) minors need to submit their



statutory representative's consent with the minor's stay in the Czech Republic; 7) 2 photographs if your appearance has changed.

**Important:** If you want to know when you can get the study confirmation for following semester look at the Directive "Enrolments" Art. Early Enrolment.

The documents submitted with the application must not be older than 180 days, except for the travel document, birth and marriage certificates and the photograph. **Please note** that you must always submit either the original document or its copy authenticated by a notary public!

## 2. Reporting changes

**It is your legal duty to report changes related to your residence!**

Foreigners are **required to report changes to their address, last name, marital status, travel documents and residence documents** related to their stay in the Czech Republic, such as their residence card. Changes are reported at a relevant office of the Ministry of the Interior. **Where:** at the office of the Ministry of the Interior where you belong according to your new address. **When:** within 3 days from the date when the change occurred. **How:** in person or through a representative with the power of attorney.

## 3. Information related to the long-term residence permit for the purpose of study

**How do I find out if my application has been processed?**

If your application has been approved, you will find its reference number listed online at [www.imigracniportal.cz](http://www.imigracniportal.cz). Also, the relevant office of the Ministry of the Interior will contact you unless you contact them first. If the processing of your application is suspended or the application is rejected, the Ministry of the Interior will send you a registered letter with the information about the result.

**How is a biometric residence card issued?**

If you find out from the website of the Ministry of the Interior that your application has been approved, you are advised to try to get an appointment for biometrics as soon as possible. After providing your biometric data, you will be given a date when you can return for your residence card. The approval of your application for a long-term residence permit becomes legally effective on the day you receive your residence card. Therefore, you need to pick up your residence card in person within 60 days from providing your biometric data.

**Please note** that if you do not pick up your card within this deadline, the processing of your application will be suspended! In order for the decision on your application for a permanent residence permit to become legally effective, you need to waive your right to appeal at the office of the Ministry of the Interior.

## 4. I am a student of ŠKODA AUTO University and I will be going home for the summer holiday and returning back in September. How should I proceed to extend my stay in the Czech Republic?

There are two options:

- A. Before the expiration of the previous long-term visa/residence permit, submit an application for extension of your stay, not earlier than 120 days and at least 1 day prior to the expiry date of the previous residence permit. (If the last day of validity of the long-term visa or long-term residence permit is a non-working day (Saturday, Sunday, holiday), the last day the application may be submitted by a foreign national is the closest PREVIOUS working day. In the event that the end of the validity period is

a working day which is not an office day, the application for validity extension of a long-term residence permit may be submitted for mail delivery on the last day of this period. This does not apply to applications that must be submitted in person; these applications must be delivered to the Ministry of the Interior no later than on the last day of the validity period. The fact that the last day of the validity period is a working day but not an office day, cannot generally be considered a reason, regardless of the cause, to prevent a foreign national from submitting the application. For this reason, all applications must be submitted in advance.) If your request will not be processed before your departure, cancel the proceedings and request a renewal of the proceedings after you return back to the Czech Republic. Based on the cancellation of the proceedings, apply for a so called "interim visa/residence sticker" at the Department for Asylum and Migration Policy. This sticker certifies your application and legality of your stay in the Czech Republic until your application has been officially processed. During this period, this sticker allows the holder to travel to/from the Schengen area. Maximum validity of the temporary sticker is 90 days.

- B. Inform the Department for Asylum and Migration Policy of your scheduled departure and provide them with your contact details so that they can contact you if necessary. Agree specifically with the clerk on your method of communication and how to proceed in the event your application will be processed while you are abroad or if any other documents need to be supplied for the purposes of the proceedings.

**Remember that if you do not respond the notices and communicate with the Department for Asylum and Migration Policy / Alien Police, your application will be rejected within the due period.**

## **5. General information**

### **Loss of a travel document or a biometric card**

**It is obligatory to report the loss of a travel document immediately!**

**Where and when:** report the loss immediately to the Police and within 3 days also to the relevant office of the Ministry of the Interior. **How:** in person or through your representative with the power of attorney.

### **Correspondence**

The authorities may send you a registered letter with important information. The letter is considered delivered 10 days after its arrival to your post office, even if you do not pick it up after receiving a notification. It is also necessary to mark your mailbox and bell with your name, so that the mail carrier can reach you.

**What happens if my mail carrier cannot reach me because I have not marked my mailbox with my name or because I do not live at my address?**

The contents of the letter will be published in the form of a public announcement on the official notice board of the relevant office of the Ministry of the Interior and also on the ministry's website. **Please note** that this letter will be considered delivered to you on the 15<sup>th</sup> day after this publication on the notice board. Please report your change of address or the extension of your rental agreement in due time!

### **Recommendation**

Always carry your biometric residence card and medical insurance card with you when you are in the territory of the Czech Republic.

Do not pay for things that you can arrange on your own or with the help of the Ministry of the Interior.

Give your power of attorney only to people you trust!  
Don't be afraid to try to arrange things on your own.  
Visit [www.imigracniportal.cz](http://www.imigracniportal.cz)

**Sending documents by post**

If you send a document to the Ministry of the Interior by post, use REGISTERED post only and keep the receipt. It is your proof of the fact that you sent the letter.

**The information line of the Department for Asylum and Migration Policy of the Ministry of the Interior of the Czech Republic** – answers only general questions in Czech and English. It does not provide information on specific case or the status of the application.

Phone: +420 974 832 421, +420 974 832 418

Email: [pobyty@mvcz.cz](mailto:pobyty@mvcz.cz), [www.imigracniportal.cz](http://www.imigracniportal.cz)

# PRACTICAL INFORMATION ABOUT LIVING IN MLADÁ BOLESLAV

## Accommodation

### Pension Uno

Address: Nádražní 287, Čejetický, 293 01 Mladá Boleslav  
web: uno.mbfirmy.cz

- app. 3 km far from the university
- fully equipped rooms
- parking
- the price for students is app. 2 700 CZK
- bus stop and main railway station nearby

### Accommodation Na Karmeli

Address: Českoobrátské náměstí 75, 29301 Mladá Boleslav  
The price for students is app. 3 800 CZK  
Contact: vjindrakova@seznam.cz



### Private Flats in Mladá Boleslav

If you decide not to accept accommodation through the school then you can arrange to rent a private flat. The prices in Mladá Boleslav are about 7 500 CZK (without electricity and water fee) a month for a one room flat with a separate kitchen and bathroom, referred to as a one-plus-one.

## Public transport

### How to get around in Mladá Boleslav

- wide network of public buses
- from Pension UNO to ŠKODA AUTO University – bus line A (every 15 minutes)
- bus timetables can be found at **[www.dpmlb.cz/index.php?page=jizdni-rady](http://www.dpmlb.cz/index.php?page=jizdni-rady) (only in CZ)**
- **map of bus stops on [www.dpmlb.cz/dokumenty/2012-06-30/planek\\_120630.pdf](http://www.dpmlb.cz/dokumenty/2012-06-30/planek_120630.pdf)**
- price for students per fare = 8 CZK

## Telecommunications

There are three main providers in the Czech Republic and they usually offer mobile tariffs, prepaid services and mobile internet connection.

**O2** Homepage: [www.o2.cz/osobni/en/](http://www.o2.cz/osobni/en/)  
**T-Mobile** Homepage: <http://t-mobile.cz>  
**Vodafone** Homepage [www.vodafone.cz](http://www.vodafone.cz)



## Foreign Currency Exchange Offices

**Exchange office (shopping centre Kaufland)**

- address: U Stadionu 1276, Mladá Boleslav
- in the shopping centre Kaufland
- transport link - bus line A, bus stop "KAUFLAND"

### Exchange office

- address: třída T. G. Masaryka 841, Mladá Boleslav
- located on the main road – T.G.Masaryk, bus stop "U SPORTU"
- ✓ we recommend that you use the wide coverage of cash machines to get best exchange rate EUR/CZK
- ✓ exchange rate approximately 1 EUR = 27 CZK

### Library of Mladá Boleslav

- located on Václava Klementa close to Česká Spořitelna
- annual fee 100 CZK for students
- 6 week loan period (can be extended)
- more info can be found at **www.kmmb.cz** (in Czech, English and German)



### Culture

#### CineStar

- biggest cinema in Mladá Boleslav
- located in Bondy Centrum
- wide selection of films in English with Czech subtitles
- prices: 159 CZK for 2D and 199 CZK for 3D
- more info at **www.cinestar.cz**



#### Theatre

- Palackého Street 263
- Performances are only in Czech
- ticket prices range from 90 to 300 CZK
- programme info at **www.divadlo.cz/mdmb**



#### Dům Kultury (Culture House)

- Street Dukelská
- social events and balls are regularly held there
- more info at **www.divadylko-nadlani.cz**
- ✓ for more information about cultural events in Mladá Boleslav is available at the Infocentre Mladá Boleslav (**Železná, 107**) or website **www.kulturamb.eu**

### Shopping

#### Bondy Centrum

- shopping centre located in the centre of Mladá Boleslav
- address: Tř. Václava Klementa 1459, 293 01 Mladá Boleslav
- opening hours daily 9:00 – 21:00



- nearly 70 shops, supermarket Billa
- restaurants, cinema, bowling centre and bars
- homepage **[www.bondy-centrum.eu](http://www.bondy-centrum.eu)**

## Olympia

- located on the outskirts of the town
- address: Jičínská 1350/III, 293 01 Mladá Boleslav
- open daily 9:00 – 21:00
- more than 50 shops, restaurants and cafes
- includes the supermarket Albert
- homepage **[www.olympia-mb.cz](http://www.olympia-mb.cz)**



## Lidl

- two supermarkets in Mladá Boleslav
- address 1: Jičínská 1369, 293 01 Mladá Boleslav
- address 2: Zahradní 1052, 293 06 Kosmonosy
- open daily
- **[www.lidl.cz/cps/rde/xchg/lidl\\_cz](http://www.lidl.cz/cps/rde/xchg/lidl_cz)**

## Kaufland

- supermarket mainly for groceries
- open daily 6:00 – 22:00
- **[www.kaufland.cz/Home/index.jsp](http://www.kaufland.cz/Home/index.jsp)**
- address: U stadionu 1276, 293 01 Mladá Boleslav
- McDonalds is next to the supermarket



## Tesco

- open **nonstop**
- address: Havlíčkova, 293 01 Mladá Boleslav
- **[www.itesco.cz/cs/obchody-tesco/extra-mlada-boleslav/](http://www.itesco.cz/cs/obchody-tesco/extra-mlada-boleslav/)**

## Sport

### Fitness Bunkr

- 1 session is 69CZK
- 1 month membership 990 CZK
- address: Havlíčkova 1000, Mladá Boleslav 293 01
- **[www.fitnessbunkr.cz](http://www.fitnessbunkr.cz)**
- opening hours daily MO – FR 7:00 – 21:00;  
SA – SU 10:00 – 20:00

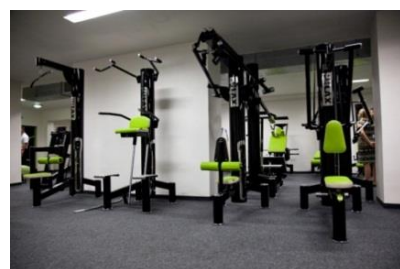

### Move Energy

- group classes
- Zumba, Yoga, Tae-Bo, Pilates, Flexi – Bar, Flowin etc.
- 1 class is 70 CZK
- for reservation +420 777 936 780
- **[www.moveenergy.cz](http://www.moveenergy.cz)**



### Golf Mladá Boleslav

- golf green, golf academy, sauna, solarium, massage and restaurant
- pricelist  
**[www.golfmladaboleslav.cz/data/cenik.pdf](http://www.golfmladaboleslav.cz/data/cenik.pdf)**
- **[www.golfmladaboleslav.cz](http://www.golfmladaboleslav.cz)**



### Swimming pool Mladá Boleslav

- address: Na Celně 1456
- length 25 m
- web **[www.bazenmb.cz](http://www.bazenmb.cz)**

### Football in Mladá Boleslav

- 1<sup>st</sup> league club FK Mladá Boleslav
- ticket prices 80 – 140 CZK
- homepage **[www.fkmb.eu](http://www.fkmb.eu)**
- possibility to hire a training pitch



### Ice Hockey in Mladá Boleslav

- ice hockey match ticket prices 85 CZK
- address of Ice Hockey Stadium: Viničná 31, 293 01 Mladá Boleslav
- homepage of hockey club **[www.bkboleslav.cz](http://www.bkboleslav.cz)**
- public ice skating (in summer in-line)

## Food & Drink

### Potrefená Husa

- wide selection of beers and wines
- delicious local cuisine and grill specialties
- address: Tř. Václava Klementa 445, Mladá Boleslav, 293 01
- 150 meters from Bondy Centrum
- **[www.phmladaboleslav.cz](http://www.phmladaboleslav.cz)**



### Kebab house

- original Turkish kebab and oriental cuisine
- address: Mladá Boleslav, tř. Václava Klementa 1459
- in Bondy Centrum
- daily open

### Steak House

- best grilled steaks in Mladá Boleslav
- address: Krátká 905, 293 01 Mladá Boleslav
- **[www.olympiacentrum.cz/steak-house/](http://www.olympiacentrum.cz/steak-house/)**





### Pizzeria Giovanni

- traditional Italian cuisine
- opening hours: daily 11:00 – 23:00
- address: Mládežnická 1117, 293 01 Mladá Boleslav II
- pizza delivery



### Restaurant Zlatý kohout

- in the historical old town
- Czech cuisine specialities
- address: Staroměstské náměstí 15/31, 293 01 Mladá Boleslav
- **[www.zlatykoehout.cz](http://www.zlatykoehout.cz)**
- separate smoking and non-smoking sections
- Wi-Fi, and summer terrace



### Forum

- restaurant and club
- disco every Friday and Saturday 20:00 – 4:00
- **<http://forum-mb.cz>**
- address: 17. listopadu 1296, 293 01 Mladá Boleslav



### Angkor

- Cambodia and Thai restaurant
- homepage **[www.angkorwat.cz/](http://www.angkorwat.cz/)**
- address: Železná ulice 51, 293 01 Mladá Boleslav



### KFC

- fast-food in Bondy Centrum
- address: třída Václava Klementa 1459, 293 01 Mladá Boleslav

### McDonald's

- address 1: U stadionu 1276/II, 293 01 Mladá Boleslav 1 (next to Kaufland)
- address 2: Jičínská 1359/3, 293 01 Mladá Boleslav



### Onyx Café

- coffee bar
- web **[www.onyxcafe.cz](http://www.onyxcafe.cz)**
- address: Na Kozině 1 (5 min. from school)



### Café Burget

- coffee bar
- web **[www.cafeburget.cz](http://www.cafeburget.cz)**
- address: Komenského nám. 85 ( 2 min. from school)



## Tips for Trips

### Mladá Boleslav´s Castle (Mladoboleslavský hrad)

- built in the 12<sup>th</sup> century
- located in the old town
- museum of Mladá Boleslav
- exhibitions "Memory of The Town", "The Country and its Changes in The March of Time", "Arms - Military weapons"
- Opening hours

**May - October** 9am - 12am, 1pm - 5pm **November - April** 9am-12am, 1pm-4pm

- entrance fee 40 CZK (app. 1,50 EUR)
- **[www.muzeum-mb.cz](http://www.muzeum-mb.cz)**
- address: Hrad 1 - Staroměstské náměstí, Mladá Boleslav 293 01



### Church of St. Havel (Kostel Sv. Havla)

- built in the late Gothic style in 1539
- in the 18<sup>th</sup> century it was rebuilt in the Baroque style
- Renaissance and Baroque tombstones from the original cemetery inside
- address: Náměstí Míru 1387, Mladá Boleslav, 293 01



### Town Hall (Radnice)

- opulent Renaissance Old Town Hall
- built between 1554 - 1559,
- work of Italian architect Matteo Borgorelli
- the facade is in the sgraffito decoration with scenes from the Old and New Testament, figures as evangelists and saints
- opened in 2001
- address: Old Town Square, 293 01 Mladá Boleslav



### Church Nanebevzetí Panny Marie

- one of the most beautiful buildings in the town
- built in 1332
- rebuilt in a Baroque style in 1702 after a fire
- address: Kateřiny Militské 58, 293 01 Mladá Boleslav I



### ŠKODA AUTO Museum

- close to the bus station and Bondy Centrum
- unique possibility to see the development of cars from the famous Czech car manufacturer
- guided tours in Czech, English, German and Russian
- address: Tř. Václava Klementa 294, 293 60 Mladá Boleslav
- adult admission 70CZK (app. 2,60 EUR)
- **<http://new.skoda-auto.com/en/experience/museum/Pages/museum.aspx>**



## Bohemian Paradise

- area of extraordinary natural diversity including characteristic sandstone rock towns, fauna and flora
- declared the first nature reserve in the Czech Republic in 1955
- situated between the towns of Mladá Boleslav, Jičín, Nová Paka and Semily
- **[www.cesky-raj.info](http://www.cesky-raj.info)**



- ✓ More information about Mladá Boleslav at **[www.mb-net.cz](http://www.mb-net.cz)**

## Health care

### FIRST AID MEDICAL SERVICES

Laurinova 333, Mladá Boleslav

Telephone number: (+420) 326 326 444

Surgery hours:	Mon – Fri	17:00 – 22:00
	Weekends and holidays	8:00 – 22:00

### KLAUDIÁNOVA HOSPITAL (HOSPITAL FOR AREA OF MLADÁ BOLESLAV)

Info centre: (+420) 326 742 111

Non – stop service

### DENTAL EMERGENCY

(+420) 326 743 721

Opening hours:	Mon – Fri	7:00 - 19:00
	Sat – Sun	9:00 – 15:00

### EMERGENCY PHARMACY

Palackého 150, hospital area

Phone: (+420) 326 743 603

Opening hours: daily 8:00 - 22:00



## FACTS ABOUT THE CZECH REPUBLIC

The aim of this chapter is to provide you with practical information and general overview of the country.



### Introduction

#### Czech flag



#### The Large and Small State Emblems



#### Land area

78,867 sq km

#### Population

10.5 million

Almost 95% of inhabitants claim to be of Czech nationality, others to Bulgarian, Croatian, Hungarian, German, Polish, Romani, Russian, Greek, Slovak, Serbian, Ukrainian and other.

#### Currency

Czech Crown (CZK/Kč)

#### Capital

Prague; population 1.2 million

#### Other major cities

Brno, Ostrava, Pilsen, Olomouc, České Budějovice

#### Historic lands

The Czech Republic is in Central Europe and consists of 3 historical lands – Bohemia (western part), Moravia (eastern part) and Czech Silesia (north-west of the country).

#### Administrative division

14 self-governing regions and municipalities

#### Official language

Czech

#### Geographical location

Central Europe

<b>Neighbouring countries</b>	Germany, Austria, Slovakia, Poland
<b>European Union member</b>	Yes, since 2004
<b>Euro currency in use</b>	No
<b>Schengen area member</b>	Yes, since 2007
<b>President</b>	Miloš Zeman (2013)
<b>Government</b>	Parliamentary democracy with president as the head of state and prime minister as the head of government.
<b>Time zone</b>	GMT+1 (U.S. EST+6, PST+9), Daylight Savings Time observed
<b>Religion</b>	Most of the population (ca 60%) is irreligious, approx. 30% inhabitants claims to belong to a certain church or a religious community.
<b>Climate</b>	Temperate, four seasons, a mix of ocean and inland climate, changeable winters, warm summers. The average daily temperature in January, the coldest of winter months is about -2°C, in July, the warmest month, about 25°C .
<b>Voltage</b>	230 Volts/50 Hz
<b>Country calling code</b>	00420 / +420
<b>Public holidays</b>	January 1, May 1, May 8, July 5, July 6, September 28, October 28, November 17, December 24 - 26
<b>Foreign languages spoken</b>	English (younger generation), German (older generation)
<b>Travel documents</b>	Passport or national ID card not required (but advised) for EU nationals arriving from a passport-free Schengen country; valid passport required for all other citizens.
<b>Safety</b>	Low rate of violent crime, high rate of pickpocketing and car theft.

## Geography

<b>Land boundaries</b>	Austria 362 km, Germany 815 km, Poland 615 km, Slovakia 197 km
<b>Terrain</b>	Bohemia in the west consists of rolling plains, hills, and plateaus surrounded by low mountains; Moravia in the east consists of very hilly country
<b>Elevation extremes</b>	lowest point: Labe (Elbe) River 115 m, highest point: Snezka 1,602 m
<b>Natural resources</b>	hard coal, soft coal, kaolin, clay, graphite, timber
<b>Land use</b>	arable land: 40.12%. permanent crops: 0.96%, other: 58.92%



<b>Natural hazards</b>	flooding
<b>Environment – current issues</b>	Air and water pollution in areas of northwest Bohemia and in northern Moravia around Ostrava present health risks; acid rain damaging forests; efforts to bring industry up to EU code should improve domestic pollution.

## History

<b>Brief overview</b>	<p>The oldest historically documented ethnic group were Celts from the beginning of the 4th century B.C. From the 6th century, the area was settled with Slavic tribes that formed the so-called Samo Empire in the 7th century. After 820, the first documented polity was formed, partially also in the area of the present republic – Great Moravia with which the beginnings of Christianity are related in this area. After its fall, creation of statehood moved to Bohemia by the beginning of the 10th century. The Přemysl's dynasty achieved consolidation of the Czech state in 995.</p> <p>From the middle of the 12th century, economic and cultural prosperity began; it was also supported by influx of German colonists. In the 13th and 14th century, the Czech state improved and stabilized on the inside, grew economically and achieved the greatest prosperity in its history. Development of education is documented by establishment of a university by the king <b>Charles IV</b> in Prague in 1348 (Today's Charles University). The deep social depression in Europe as well as within the Czech state at the turn of the 14th and 15th century led to the <b>Hussite movement</b> that transformed from the original movement for the Church reformation into a militarized popular resistance – the Hussite wars. Since the Middle Ages, the borders of the main historical countries have not change very significantly, other lands were always only a temporary part of the Czech state. In 1526, the Lands of the Bohemian Crown became a part of the <b>Hapsburg Empire</b>.</p> <p>After the fall of the monarchy (the Austro-Hungarian Empire), Czechoslovakia was formed of the historical Czech lands (Bohemia, Moravia, Silesia) with parts of the former Kingdom of Hungary (Slovakia and Carpathian Ruthenia) as one of the successor states of the Austro-Hungarian Empire (related to the personality of T. G. Masaryk) due to the World War I in 1918. After the <b>Munich Agreement of 29. 9. 1938</b>, the Nazi Germany occupied the Czech borders (this was also supported by the disloyal approach of a considerable part of German national minority towards the Czech state); subsequently, Germany occupied also the remainder of the land and established the <b>Protectorate of Bohemia and Moravia</b>. In Slovakia, an autonomous state was established which became a Nazi Germany satellite. After the World War II, the Czechoslovakia was renewed in 1945 (without Carpathian Ruthenia) and at the same time, a three-million German minority was displaced and forced out of the country. In February 1948, the Communist party performed a coup d'état and introduced a totalitarian rule in the country. In the 1960s, the totalitarian rule was partially loosened; this was however stopped in <b>August 1968</b> by a <b>military intervention</b> by the USSR and other countries of the Warsaw</p>
-----------------------	---



Pact.

**The fall of the Communist regime** in November **1989** (so-called "Velvet Revolution") allowed renewal of multi-party democracy). In December 1989, Václav Havel (one of the founders of the underground movement Charter 77) was elected the first non-Communist president since 1948. In the following years, withdrawal of the Soviet occupation forces was achieved and there were some democratic reforms within the state. By the end of 1992, the Czech and Slovak sides reached an agreement of division of the Czech and Slovak Federal Republic into two autonomous states. **By 1 January 1993, the Czech Republic came to origin** due to the break of the Federal Republic. The Czech Republic joined NATO in 1999 and the European Union in 2004.

### **Independence**

**1 January 1993** (Czechoslovakia split into the Czech Republic and Slovakia); note - although 1 January is the day the Czech Republic came into being, the Czechs commemorate 28 October 1918, the day the former Czechoslovakia declared its independence from the Austro-Hungarian Empire, as their independence day

### **Famous Czechs**

**Charles IV.** (1316 – 1378)

King Charles IV (Karel IV), Czech king and Holy Roman Emperor. He founded Central Europe's first university and initiated the construction of many of Prague's great Gothic monuments. During his reign, Prague grew into one of the largest and most important cities in Europe.

**John Amos Comenius (Jan Ámos Komenský)** (1592 – 1670)

Comenius wrote several textbooks on education (e.g. Orbis Pictus), which were so original that they won him the name "the father of modern education".

**František Palacký** (1798 – 1876)

Czech nationalist and historian. He is considered to be the "father of the modern Czech nation". Palacký played a leading role in the Czech cultural and national revival of the 19th century.

**Tomáš Garrigue Masaryk** (1850 – 1937)

The first Czechoslovak president, under whose presidency Czechoslovakia was a strong democratic country and one of the most developed countries in the world. Apart from being politician, Masaryk was also a philosopher and a sociologist.

**Václav Havel** (1936-2011)

A Czech writer, dramatist and politician. His first publicly performed full-length play, The Garden Party (1963), presented in a season for the Theatre of the Absurd, won him international acclaim. Havel became a leading figure in the Velvet Revolution of 1989. He was the ninth and last President of Czechoslovakia and the first President of the Czech Republic.

## **Living in the Czech Republic**

### **Cost of living**

The average living costs of students range from 8 500 CZK /month, incl. meals, accommodation, public transport and culture. Dependent on

	student's needs and interests.	
	Dormitory	3 000 – 4000 CZK / month
	Private flat	from 8 000 CZK / month
	Lunch at the school canteen	around 50 CZK / meal
	Restaurant meal	from 120 CZK / meal
	A loaf of bread	from 25 CZK
	1 kg of meat (chicken)	from 100 CZK
	Dairy products	from 25 – 50 CZK
	Cinema ticket	from 100 CZK
	Theatre ticket	from 100 CZK
<b>Public holidays</b>	People usually don't work on these days. Schools, shops, banks, post offices and hospital outpatient departments are closed.	
	January 1	Foundation Day of the Czech Republic in 1993
	Easter Monday	Easter Holiday
	May 1	Labour Day
	May 8	Liberation Day: the end of World War II
	July 5	The feast of St. Cyril and St. Methodius: the arrival of the Christian missionaries sent from the Byzantine Empire to the Czech Lands
	July 6	Jan Hus Day: commemoration of the religious reformer's death at the stake in 1415
	September 28	St. Wenceslas' Day: in remembrance of the patron saint of the Czech State
	October 28	Czechoslovak Statehood Day: this day commemorates the establishment of democratic Czechoslovakia in 1918
	November 17	Freedom and Democracy Day – commemorating the anti-Communist demonstrations of 1989
	December 24	Christmas Eve
	December 25, 26	Christmas Holidays
<b>Local cuisine</b>	<p>Traditional Czech cuisine reflects the influence of neighbouring countries: German roast goose, Austrian schnitzel, Hungarian goulash, etc. Typical Czech food is mostly based on meat, flour and sauce. In recent times, Italian cuisine and healthy diets have become fashionable among young people.</p> <p>Vepřo-knedlo-zelo: roasted pork served with sour cabbage and dumplings; the most typical Czech dish.</p> <p>Svíčková: pot-roasted marinated beef in a rich creamy vegetable sauce, served with cranberries, whipped cream and dumplings.</p> <p>Ovocné knedlíky: fruit-filled dumplings, served with sugar and curd.</p> <p>Koláče: small pastries topped with almonds, poppy seed, jam, or a sweet curd cheese.</p>	
<b>Vocabulary</b>	<b>Pozdravy</b>	<b>Greetings</b>
	Dobrý den	Good day (suitable for use all day)
	Na shledanou	Good-bye

Ahoj	Hello (also Bye) – informal greeting
Děkuji	Thank you
Není zač	Not at all, you're welcome.
Promiňte	I'm sorry. Excuse me.
Prosím	Please
Jak se máte?	How are you?
Jmenuji se ...	My name is ...
Neumím česky.	I don't speak Czech.
Mluvíte anglicky?	Do you speak English?
Kolik to stojí?	How much does it cost?
Cena	Price
Kde je...?	Where is...?
Nevím.	I don't know.
<b>Osobní údaje</b>	<b>Personal data</b>
Příjmení	Surname
Jméno	First name
Datum narození	Date of birth
Země	Country
Bydliště	Residence; Address
Povolání	Profession
Pas	Passport
<b>Nápisy</b>	<b>Notices</b>
Divadlo	Theatre
Hospoda	Inn, Pub
Jízdní řád	Timetable
Kino	Cinema
Letiště	Airport
Nemocnice	Hospital
Pokladna	Box Office, Cash Counter
Policie	Police
Pošta	Post Office
Pozor!	Watch out!
Příjezdy/Odjezdy	Arrivals/Departures
Restaurace	Restaurant
Směnárna	Bureau de Change
Stanice	Station/s, stop/s
Vchod	Entrance
Východ	Exit
Zavřeno/Otevřeno	Closed/Open
Záchod(ky), toalety	Lavatory, toilets

## Education system

Education is based on equal approach to education with no discrimination, on taking education needs of an individual into account, on mutual respect, opinion tolerance, solidarity and respect for dignity of all education participants. Primary and secondary education of citizens of the Czech Republic or any other EU Member State in schools operated by the state, region or municipality is free. The education system allows everyone to educate themselves for their entire lives.

**Preschool education** is offered at crèches and nursery schools as a complement to family-based education.

**Elementary education** – nine-year school attendance is compulsory from the age of 6 till the age of 15.

**Secondary education** - pupils who have fulfilled their nine-year compulsory school attendance can apply for study at secondary schools. Secondary education can be achieved by students also in their eighth class level or, more precisely, six-year grammar schools at which they have already completed several classes of elementary education.

**Tertiary education** - tertiary education is included in studies following a completed secondary education with a leaving exam. Tertiary education includes advanced vocational and university education.

**Higher vocational education** - The teaching system is almost identical with the system at the college or vocational college; however, certain rules of secondary education apply (holidays, fixed timetables, etc.). Higher vocational education deepens upon general and professional knowledge and takes three years in the daily form, hands-on training included, and three and a half years for medicine and certain other fields of study. Studies are completed with a certificate, a specific exam on selected subjects, a practical exam and the defence of a graduate examination paper. Of course, everything in relation to the subject studied. Together with the certificate, students are awarded the title of certified specialist (the abbreviation Dis. is added after a surname).

**University education** is available to all applicants with completed secondary education (i.e. leaving exam), who successfully pass the entrance exam. The system of entrance exams is specified individually by each college, and serves for testing the knowledge and skills of applicants.

Most universities have the following accredited degree programmes:

**Bachelor's:** Usually a three-year course of study in which students receive an elementary overview of highly specialized areas. Students can either leave their studies after these three years, or they can complete it by means of a leaving exam including defence of a Bachelor's thesis, or may continue into the Master's programme, where they can achieve a narrower specialization.

**Master's:** Operates either as a five-year (or, more precisely, six-year), or two-year programme following Bachelor studies. During the course, students gain both a basic overview of highly specialized subjects and a certain level of specialization. The programme culminates with students taking required state leaving exams and defending their diploma theses.

**Engineering:** Relates to technical and economic fields.

After students pass these types of university study, some continue in their specialization through Doctoral programmes. Passing these programmes is often conditioned on certain publication work and sometimes also by training.

At college, students can study either in attendance form (formerly daily study), distance form (formerly extramural studies), or combine both forms of study (combined study).

Besides standard types of study, colleges offer also other forms of education: retraining study, third age university, studies oriented toward pedagogical qualification, etc.

Some schools in the CR provide study programmes leading to the Degree of Master's of Business Administration (MBA).

**Further education** - within the frame of ongoing education programmes, universities implement a variety of courses intended e.g. for those who are interested in study, university graduates, seniors, and also students and employees interested in studies. The courses focus either on learning a skill or trade, or on the study of areas of interest. In addition, some universities organize so-called Third age universities. This is intended for seniors who are interested in gaining new knowledge in selected areas of study, and is usually free.

## TRANSPORT IN THE CZECH REPUBLIC

### Public transport

The public transportation system in the Czech Republic is generally reliable, safe and cheap. The system covers buses, trains, trams and in Prague metro as well.

#### Municipal transport

The municipal transport includes primarily (the system varies according to the city size and local situation) transport by bus, tram, trolleybus or subway(only Prague). The transport is paid and every city has its own tariff system. It is necessary to pay transport fees also for transport of dogs and luggage in case they fail to meet conditions of free transport. Payment of the transport fee is checked by ticket controllers and failure to pay the fee is penalized with a high fine.

More detailed information about the transport fees and schedules may be obtained in person, via telephone or on the Internet website of the individual public transport companies.

In some cities of the Czech Republic, the transport is integrated which means that tickets for the applicable zone designed for city transport may also be used for suburban transport in the outlined area of the cities and between them. In integrated transport systems, the individual transport types (bus, train, etc.) cooperate and form a network of interwoven lines with a unified tariff, transport conditions and regular intervals between the lines.

In Mladá Boleslav you can pay only with coins! The bus machines do not pay back.

#### Intercity transport

Intercity transport in the Czech Republic includes primarily bus or train transport. Domestic air transport is used only marginally, between the biggest cities (Prague, Brno, Ostrava). Intercity bus transport is provided by a wide range of transport providers in the Czech Republic. Each of these providers has their own tariff system that offers single tickets as well as pre-paid passes. Similarly as public transport companies, most bus transport providers offer discounts for certain passenger groups (e.g. to students, disabled people, seniors, children up to a certain age, etc.).

More information on the amount of bus or railway transport fees, discounts, transport conditions and schedules is available e.g. on the website **[www.idos.cz](http://www.idos.cz)**, in information centres or at bigger bus stations or railway station.

This website allows searching connections in every type of transport separately or combined and therefore finds an optimum connection.



### Public transport in Prague

The best way to get around Prague is by metro. The Prague metro is an open ticket system. Passengers are obliged to buy and validate a ticket before entering the metro platform. There are uniformed ticket inspectors who have the right to check the validity of the ticket at any time inside the metro area.

At the metro entrance be sure to stamp your ticket in the machine otherwise it is invalid and you will be liable for a fine as ticket inspectors regularly patrol metro stations. The price of a short trip (max. five stops only on one line) is 24 CZK, for a one hour trip it is 32 CZK and for all day ticket it is 110 CZK. You can change lines with the last two tickets, providing it is within

the designated time period. Please also note that you may also have to purchase a ticket for large luggage.

Public transport tickets and passes						
TICKET / PASS TYPE	Adult	Child <sup>x</sup>	Junior	Student <sup>+</sup>	Senior <sup>x</sup>	
<b>Tickets</b>	<b>Basic</b> 90 min.	32 CZK	16 CZK	32 CZK	32 CZK	16 CZK
	<b>Short-term</b> 30 min.	24 CZK	12 CZK	24 CZK	24 CZK	12 CZK
	<b>1 day</b> 24 hrs.	110 CZK	55 CZK	110 CZK	110 CZK	55 CZK
	<b>3 days</b> 72 hrs.	310 CZK	•	310 CZK	310 CZK	•
• No reduced fares for this tariff group.						

Luggage transport	
 16 CZK	 0 CZK

✓ **payment only in CZK**

You need to purchase your ticket(s) before traveling and you can get these in the airport at the transport information desk, which is in the arrivals hall. Choose 90 min.

If you have luggage larger than 25x45x70 cm then you need to buy a ticket for it as well.

Please note that employees on public transport usually do not speak English.

## The right to drive

The right to drive is necessary in order to drive a vehicle in the Czech Republic; it is documented by a driving license. The holder of the driving license is obliged to carry the driving license when driving a vehicle on him/her and to submit it to control upon request.

A driving license issued in a European Community member state also entitles its holder to drive motor vehicles in the Czech Republic; driving license and an international driving license. If you are not sure whether your driving license issued by a foreign country is valid in the Czech Republic you can ask at the Ministry of the Interior office CR for more information.

In the Czech Republic, utilization of a selected network of motorways and highways is subject to a fee payment. Payment of a highway fee is documented with a highway coupon. Highway coupons are available at petrol stations, in the Czech Post offices, at frontier crossings or auto-clubs. It is possible to purchase coupons valid for one year, one month or ten days.

### Maximum speed in the Czech Republic:

city: 50 km/h

outside the city: 90 km/h

highway: 130 km/h

In the Czech Republic it is not allowed to drive a car after the consumption of alcoholic beverages or other drugs regardless of the quantity of the consumption.



## How to Get From Prague Airport to Mladá Boleslav

### a. Take a bus to a metro station

- Bus Nr. 119 Airport - Dejvická (Metro line A)
- Bus Nr. 100 Airport - Zličín (Metro line B)
- Bus Nr. 179 Airport - Nové Butovice (Metro line B)
- Bus Airport Express Airport - Main railway station

Travel by metro to either the last metro station **Černý Most** on the yellow B line (Bus station)

or

to the station **Hlavní nádraží** (Main train station).

### b. Find a connection to Mladá Boleslav (you can use portal [www.idos.cz](http://www.idos.cz))

#### By bus

- From Černý Most – last metro station on yellow B line
  - Take the bus to Mladá Boleslav (Bondy Centrum)
- price for one bus route around 70 CZK (please note that you will also pay extra for luggage)
  - very good connection which runs approximately every 20 minutes

#### By train (you can use portal [www.idos.cz](http://www.idos.cz))

- Travel by metro to the station Hlavní nádraží (Main railway station)
- Travel by train to Mladá Boleslav (Main train station – Hlavní nádraží); price is around 100 CZK

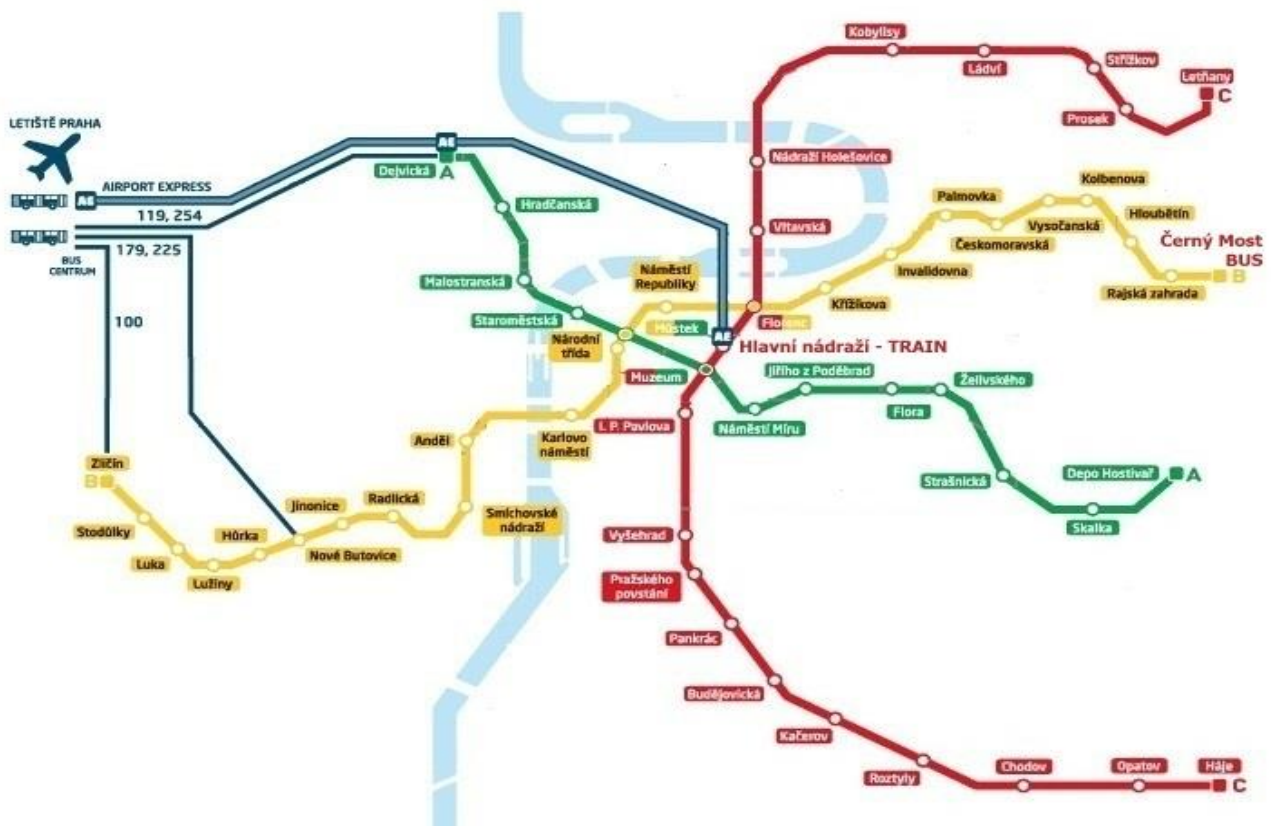

Map of the metro stations in Prague

## How to Get to ŠKODA AUTO University/Accommodation Na Karmeli

**School address:**

**ŠKODA AUTO University, Na Karmeli 1457, Mladá Boleslav**

**Accommodation Na Karmeli – address:**

**Českoobratrské náměstí 75, Mladá Boleslav**

### From the main train station in Mladá Boleslav

- Take the bus Line A.
- Get off the bus at the stop **Náměstí míru**.
- Look at the Map 1 and the follow black line.

### From the bus station (Bondy Centrum) in Mladá Boleslav

- Go to the bus stop **Václava Klementa** next to Bondy Centrum.
  - Take the bus C and get off at **Komenského náměstí**.
- On foot follow the directions on map 1

**or**

On foot from the bus station and follow the directions on the Map 2 (15 minute walk)

- Price for one trip by public transport bus is 15 CZK. (You can purchase tickets on the bus. It is possible to pay only with coins.)

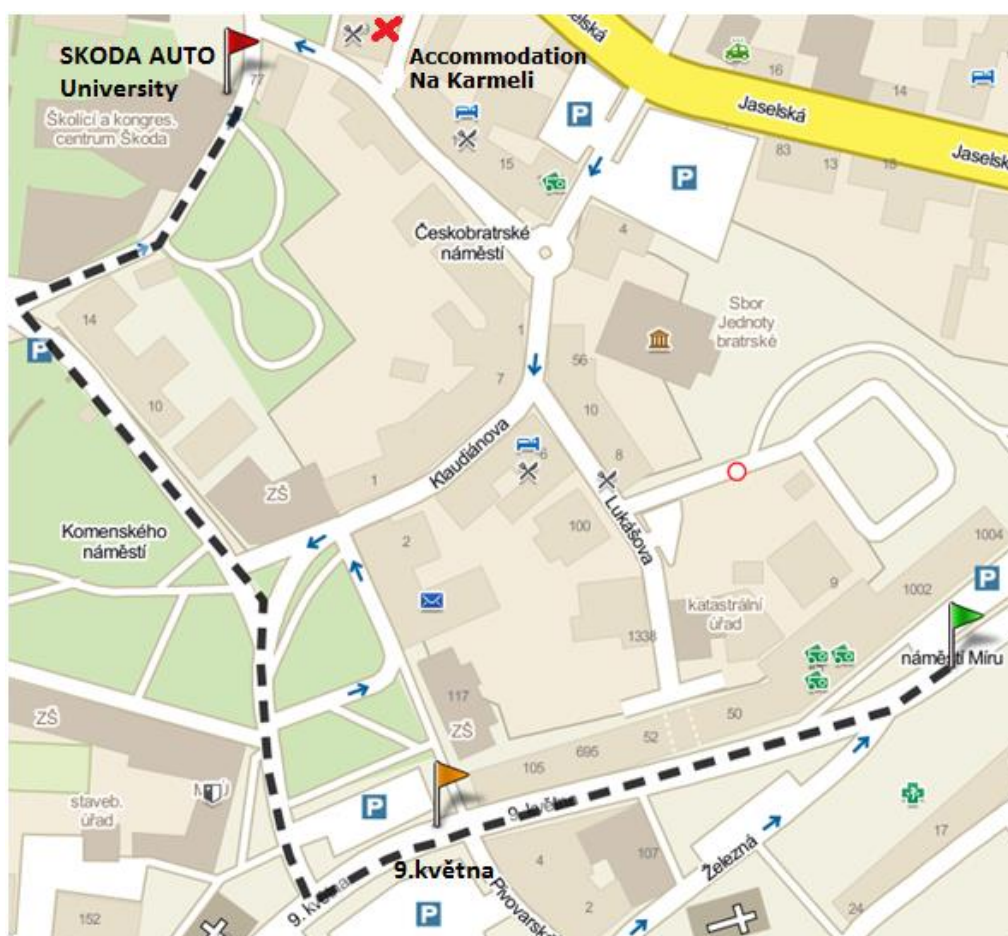

**Map 1: Náměstí Míru -> ŠKODA AUTO University / Accommodation Na Karmeli**



**Map 2: Bus station -> ŠKODA AUTO University / Accommodation Na Karmeli**

## How to Get to Pension UNO (Accommodation)

### Address:

Čejetičky – U Cukrovaru 287, 293 01 Mladá Boleslav

### From the main train station in Mladá Boleslav

- a. On foot follow the directions on map 3 (300 m).

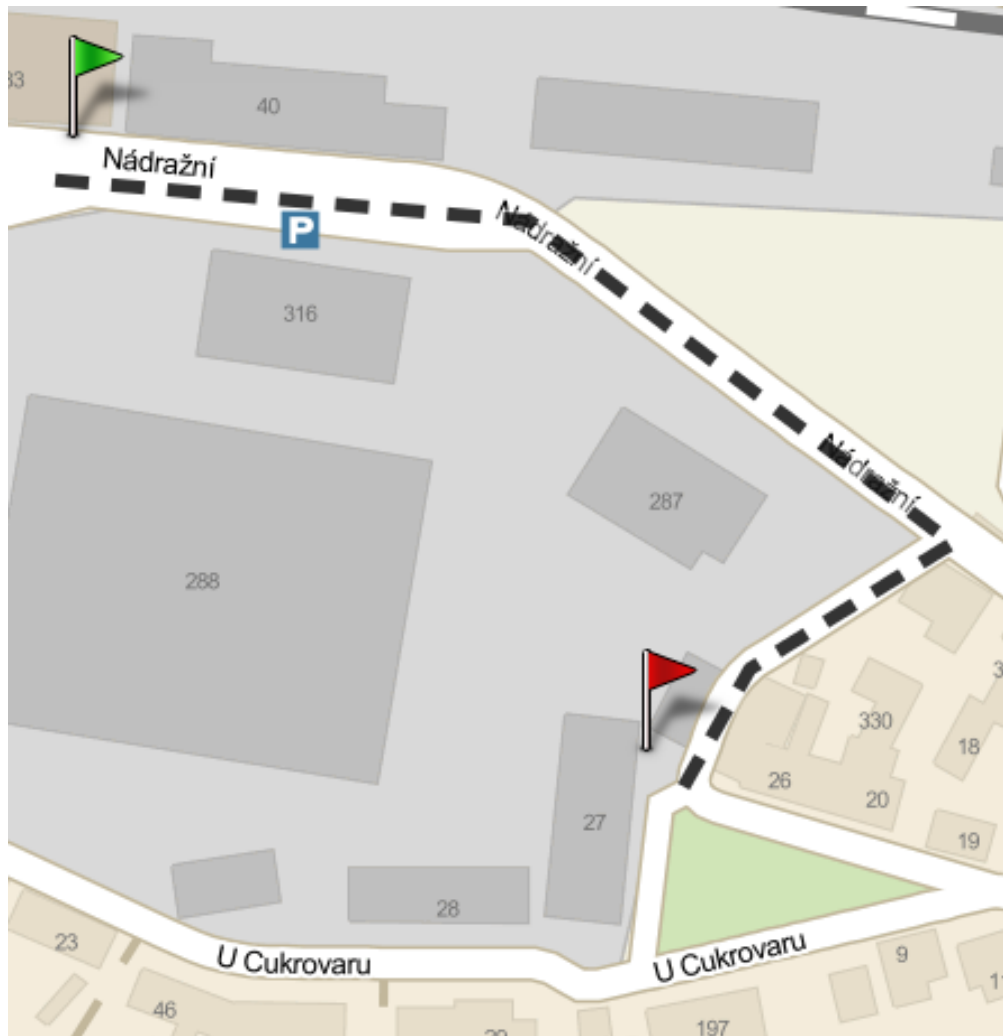

**Map 3: Main train station -> Pension UNO**

### From the bus station (Bondy Centrum) in Mladá Boleslav

- a. On foot follow the directions on map 4 to the bus stop **Pod nemocnicí**.
  - b. Take the bus line A and get off at **Čejetičky, most**.
  - c. On foot follow the directions on map 5 (200 m).
- Price for one trip on public transport bus is 15 CZK. (You can purchase tickets on the bus. It is possible to pay only with coins.)





**Map 4: Bus station -> Pod nemocnicí**

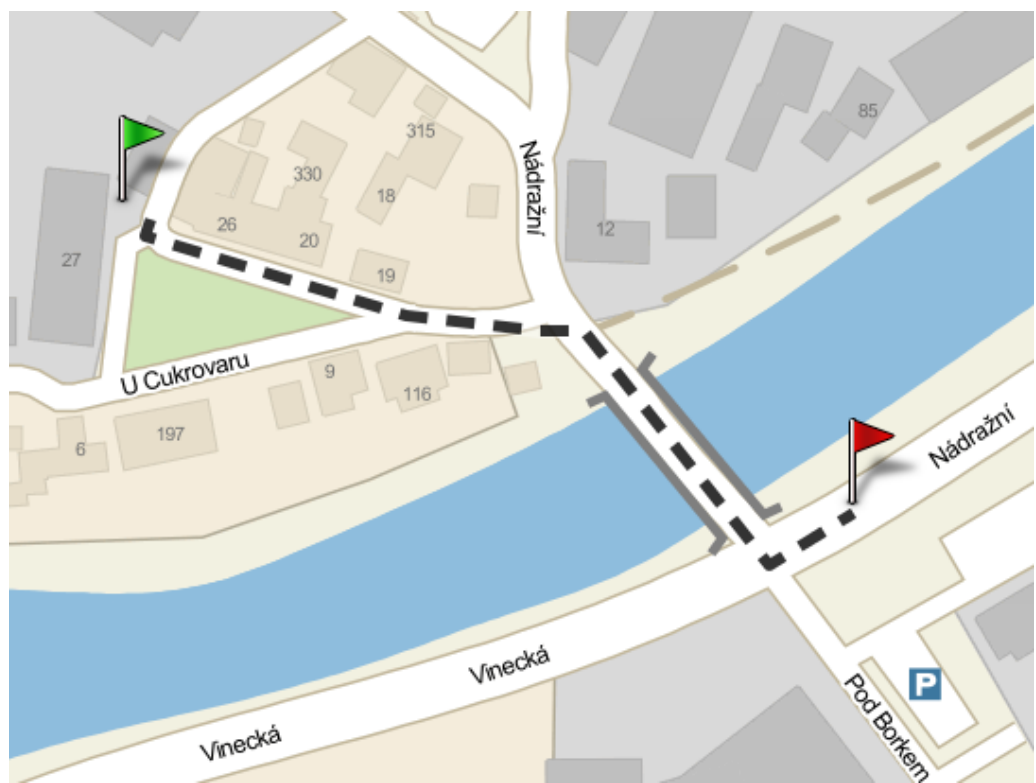

**Map 5: Čejtičky, most -> Pension UNO**

## From ŠKODA AUTO University

- a. Look at Map 1 and go to the bus stop **9. Května**
- b. Take the bus line A and get off at **Čejetický, most.**
- c. On foot follow the directions on map 5 (200 m).

## Useful Links

- ✓ public transport connections in the Czech Republic **[www.idos.cz](http://www.idos.cz)**
- ✓ information about Prague airport and transportation links **[www.prg.aero](http://www.prg.aero)**
- ✓ information about public transport in Prague **[www.dpp.cz](http://www.dpp.cz)**

## MAP OF MLADÁ BOLESLAV AND IMPORTANT PLACES

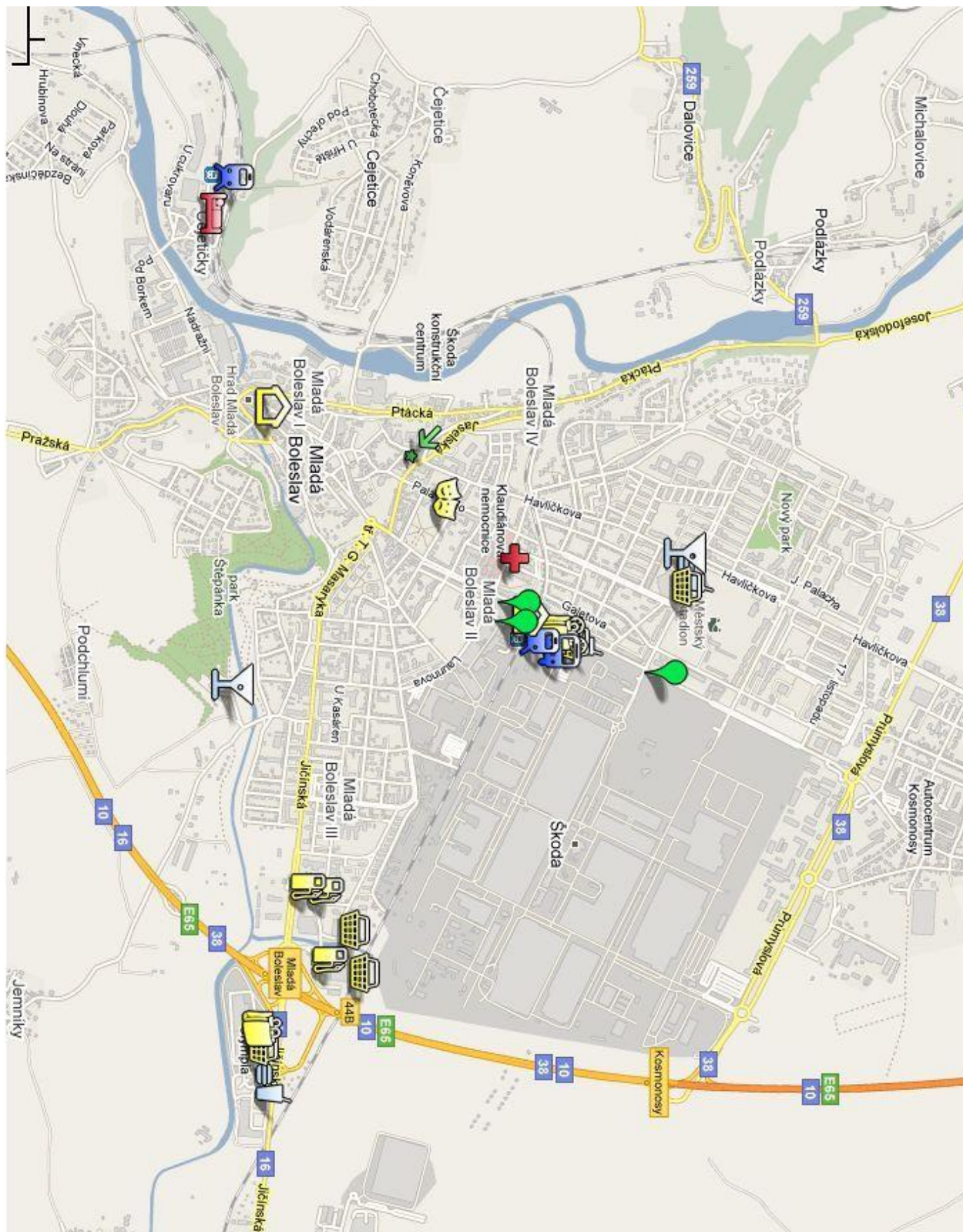



	<a href="#">Škoda Auto Vysoká škola, a. s.</a> Budova vysoké školy a sídlo Studentké unie Škoda		<a href="#">Kaufland</a> U stadionu 1276, 293 01 Mladá Boleslav II Zelená
	<a href="#">Penzion UNO</a> Oficiální kolej ŠAVŠ <a href="http://uno.mbfirmy.cz/">http://uno.mbfirmy.cz/</a>		<a href="#">Muzeum - Škoda Auto</a> Škoda Auto Muzeum Václava Klementa 294 293 60
	<a href="#">Bondy centrum</a> <a href="http://www.bondy-centrum.eu">http://www.bondy-centrum.eu</a> tř. Václava Klementa		<a href="#">OMV Jičínská I. čerpací stanice</a>
	<a href="#">Cinestar</a> <a href="http://www.cinestar.cz/flash/index.aspx">http://www.cinestar.cz/flash/index.aspx</a> Bondy		<a href="#">OMV Jičínská II</a>
	<a href="#">Nemocnice / Hospital</a> <a href="http://www.klaudianovanemocnice.cz/">http://www.klaudianovanemocnice.cz/</a> V. Klementa		<a href="#">Shell Mladá Boleslav</a>
	<a href="#">Olympie MB - shopping</a> <a href="http://www.olympia-mb.cz/">http://www.olympia-mb.cz/</a> Jičínská 1350/III 293 01		<a href="#">Muzeum / Castle</a> <a href="http://www.muzeum-mb.cz/">http://www.muzeum-mb.cz/</a> Muzeum
	<a href="#">mcdonald's</a>		<a href="#">Olympia Centrum - Bowling</a> Zábavní komplex Olympia Centrum Krátká 905
	<a href="#">KFC</a> <a href="http://www.bondy-centrum.eu/">http://www.bondy-centrum.eu/</a> Bondy centrum tř.		<a href="#">Škoda 8. brána</a>
	<a href="#">RESTAURACE KOLIBA</a> Na Štěpánce 1184 293 01 Mladá Boleslav tel: +420		<a href="#">Škoda 1. brána</a>
	<a href="#">Městské divadlo Mladá Boleslav</a> <a href="http://www.mdm-b.cz/index.php">http://www.mdm-b.cz/index.php</a> Palackého 263, 293		<a href="#">Technická knihovna</a> Průchod přes 1. bránu
	<a href="#">McDonald's</a> Jičínská 1350, 293 01 Mladá Boleslav III (Olympia		<a href="#">Mladá Boleslav - Hlavní nádraží</a> Hlavní vlakové nádraží
	<a href="#">Interspar Jičínská</a>		<a href="#">Mladá Boleslav - město</a> Nádraží město
	<a href="#">Albert Hypermarket</a> <a href="http://www.olympia-mb.cz/">http://www.olympia-mb.cz/</a> Jičínská 1350/III 293 01		<a href="#">Autobusové nádraží</a>
	<a href="#">Lidl</a> Adresa: Jičínská 1369, 293 01 Mladá Boleslav III		
	<a href="#">Billa</a> tř. Václava Klementa 1459, 293 01 Mladá Boleslav II		

## **IMPORTANT CONTACTS**

### **POLICE**

**158**

### **FIRE DEPARTMENT**

**150**

### **AMBULANCE**

**155**

### **INTERNATIONAL EMERGENCY**

**112**

### **FOREIGN POLICE IN MLADÁ BOLESLAV**

**+420 974 877 300**

## **STUDY AFFAIRS DEPARTMENT**

**(Language of communication: Czech)**

**Jana Šťastná**

**+420 326 8 230 40**

**jana.stastna@savs.cz**

**(Language of communication: English)**

**Ing. Lucie Bydžovská**

**+420 326 8 230 42**

**lucie.bydzovska3@savs.cz**

## **INTERNATIONAL OFFICE**

**Ing. Alena Rychtářová**

**International Office Specialist**

**(Language of communication: Czech,  
English)**

**+420 326 823 049**

**rychtarova@is.savs.cz**

**Bc. Daniel Suchánek**

**Erasmus Coordinator**

**(Language of communication: Czech,  
English)**

**+420 326 823 003**

**suchanek@is.savs.cz**

**The communication with the Study Affairs Department and International Office is held only in the Czech and English language.**

